











LEGEND

	EXISTING DECK		FOUND CHISELED CROSS
	EXISTING STONE		FOUND 1" IRON PIPE
	EXISTING CONCRETE		CHAIN LINK FENCE
	EXISTING BUILDING		ELECTRIC OVERHEAD LINE
	RECORDED AS		POWERPOLE
			CATCH BASIN

# PLAT OF SURVEY

A PARCEL OF LAND LOCATED IN THE SOUTHWEST 1/4 OF THE NORTHEAST 1/4 OF SECTION 18 IN TOWNSHIP 1 NORTH, RANGE 17 EAST, IN THE TOWN OF LINN, WALWORTH COUNTY, WISCONSIN.

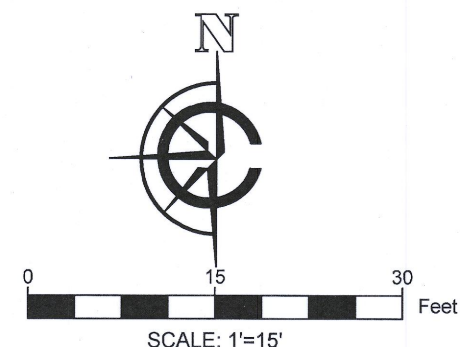
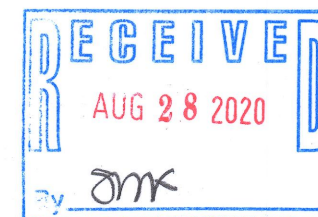

NOTE:  
1. BASIS OF BEARING: THE WISCONSIN STATE PLANE COORDINATE SYSTEM, NAD-83, SOUTH ZONE.  
2. FIELD WORK COMPLETED MARCH 18TH, 2020  
FIELD CREW CHIEF: LOGAN RANDLE  
3. BUILDING SURVEYED TO THE EXTERIOR OF SIDING.

LEGAL DESCRIPTION:

A PARCEL OF LAND LOCATED IN THE SOUTHWEST 1/4 OF THE NORTHEAST 1/4 OF SECTION 18 IN TOWNSHIP 1 NORTH, RANGE 17 EAST, IN THE TOWN OF LINN, WALWORTH COUNTY, WISCONSIN, MORE PARTICULARLY DESCRIBED AS:

LOT 21 SHORE HAVEN SUBDIVISION AS RECORDED IN THE DOCUMENT #P256485 IN THE WALWORTH COUNTY REGISTER OF DEEDS

SURVEY ORDERED BY:

PAUL LAZZARONI

PROPERTY ADDRESS:

N1573 SHORE HAVEN  
FONTANA, WI 53125

SURVEYOR:

PAUL H. VAN HENKELUM, PLS  
CARDINAL ENGINEERING LLC

"I HEREBY CERTIFY THAT I HAVE SURVEYED THE ABOVE DESCRIBED PROPERTY AND THE MAP IS A TRUE AND CORRECT REPRESENTATION OF ITS EXTERIOR BOUNDARIES AND SHOWS THE SIZE AND LOCATION OF ALL VISIBLE STRUCTURES, APPARENT EASEMENTS AND ENCROACHMENTS, IF ANY."

*Paul H. Van Henkelum*  
PAUL H VAN HENKELUM, PLS #1931

DATE

*3/24/2020*

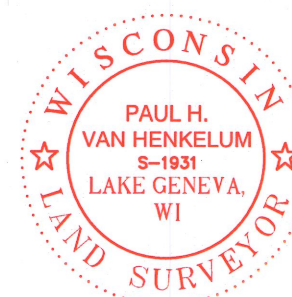

CARDINAL ENGINEERING LLC  
DESIGNING IN TRUE DIRECTIONS

1200 LA SALLE ST  
LAKE GENEVA, WI 53147  
262-757-8776  
CARDINALENGINEERINGWI.COM

DATE: 03/24/2020 JOB No. 20328  
SHEET 1 OF 1

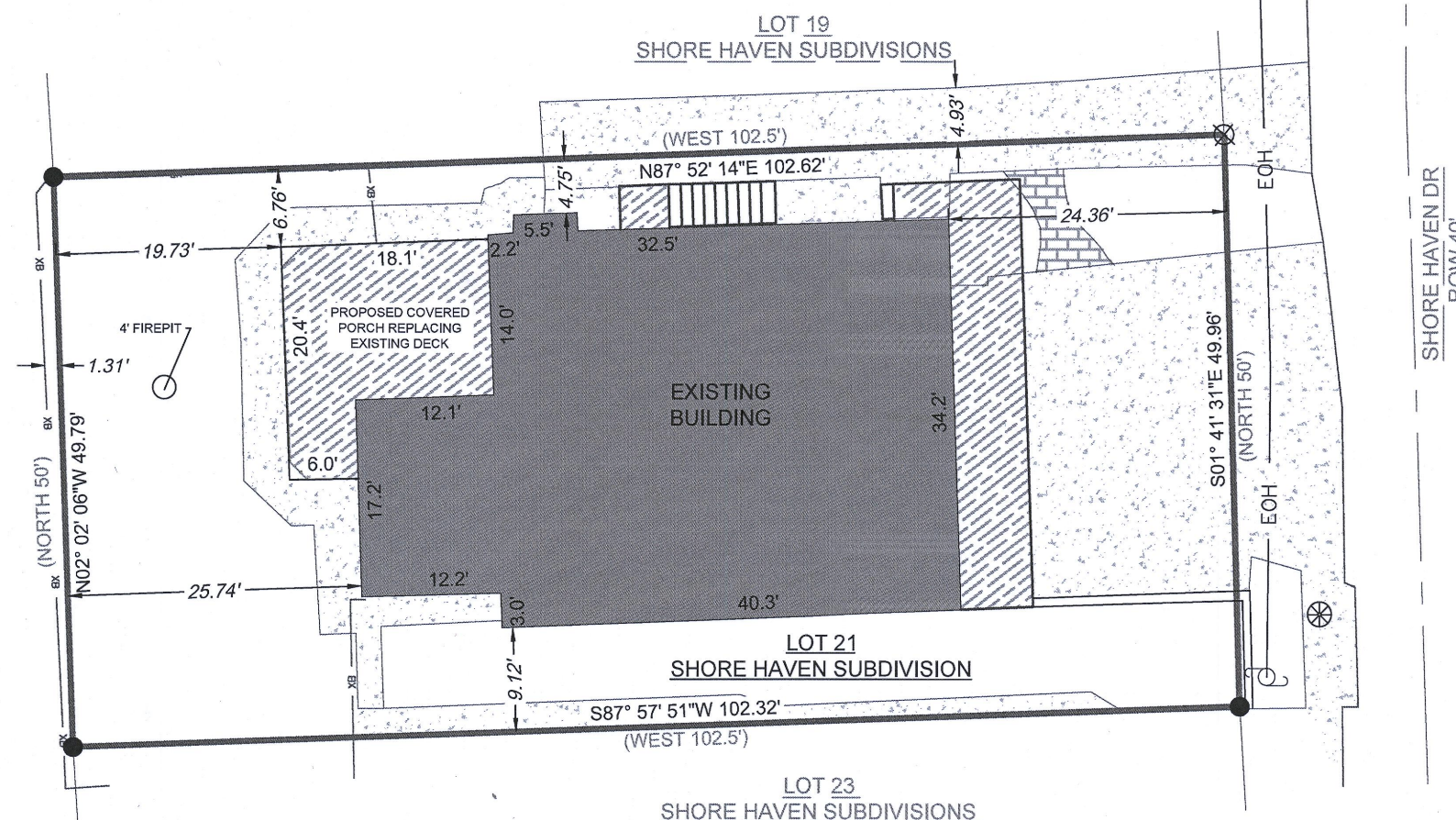

UNPLATTED LANDS  
IL 1800009

PRIVATE DRIVE

SHORE HAVEN DR  
ROW 40'

ISA-20

117-4383